



## Hope Close, London, NW4 1AY

£435,000 - Leasehold

**\*\*CHAIN FREE\*\*** A fantastic 2 double bedroom, 2 bathroom REAR facing apartment situated on the first floor of this modern purpose built block. Finished to a very high standard, the property features a 19ft reception room with direct access to a private balcony overlooking communal gardens and an open-plan kitchen. Further benefits include an en-suite bathroom to the master bedroom, a large storage cupboard, an allocated underground parking space and a passenger lift. The flat would make an ideal first time purchase.

Lease: Approx. 115 years remaining  
Ground Rent: £350 per annum  
Service Charge: Approx. £2400 per annum

- Purpose built
- 2 double bedrooms
- 2 bathrooms (1 en-suite)
- Balcony
- Communal gardens
- Underground parking space
- Chain free
- Lift
- Ideal first time purchase
- Barnet council tax band E

## Floor Plan

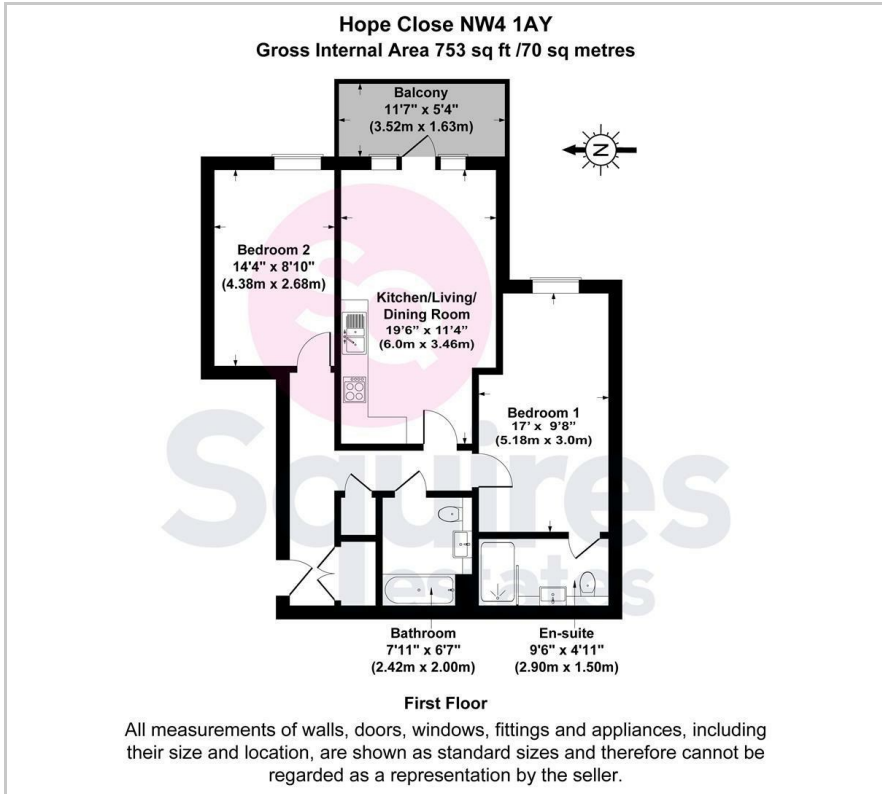

## Area Map



## Energy Efficiency Graph

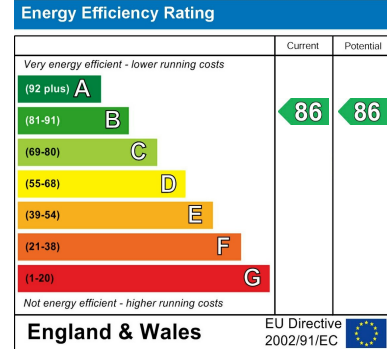

These particulars, whilst believed to be accurate are set out as a general outline only for guidance and do not constitute any part of an offer or contract. Intending purchasers should not rely on them as statements of representation of fact, but must satisfy themselves by inspection or otherwise as to their accuracy. No person in this firm's employment has the authority to make or give any representation or warranty in respect of the property.

### Finchley Branch

181a Squires Lane,  
Finchley,  
London N3 2QS  
Tel 020 8343 2111

### Hendon Branch

16 Central Circus Parade,  
Queens Road, Hendon,  
London NW4 3AS  
Tel 020 8202 0808

### Mill Hill Branch

7 Thornfield Parade,  
Holders Hill Road, Mill Hill,  
London NW7 1LN  
Tel 020 8349 3030

